

**BULLETIN  
No. 1800**

REVISED 8/1/89

**SHHH... SHHH**

# SHOCK-PROOF PIPING SYSTEMS

**Factory Mutual System**

\*Approved

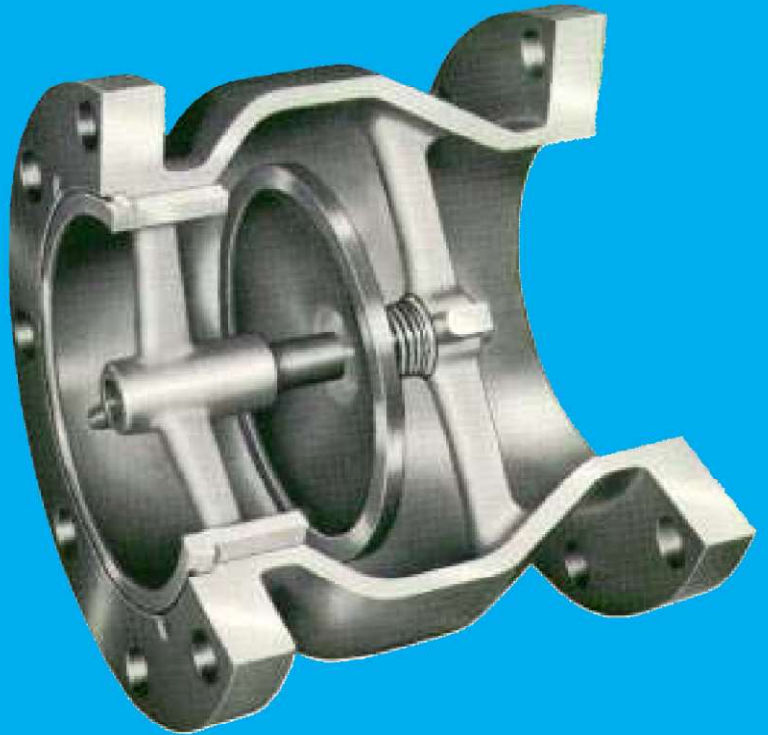

**1800 SERIES**

## with **VAL-MATIC**<sup>®</sup> **GLOBE STYLE Silent Check Valves**

Designed and engineered for Silent operation with Low head loss. Specially designed spring controls the closure of Val-Matic Silent Check Valves . . . closing valve disc in advance of flow reversal, thereby preventing water hammer and damaging shock normally associated with valve shut-off.

Tear-Drop Contour **allows** streamline flow and combined with greater than Pipe Size Area of Inner Body **assures** minimal pressure drop.

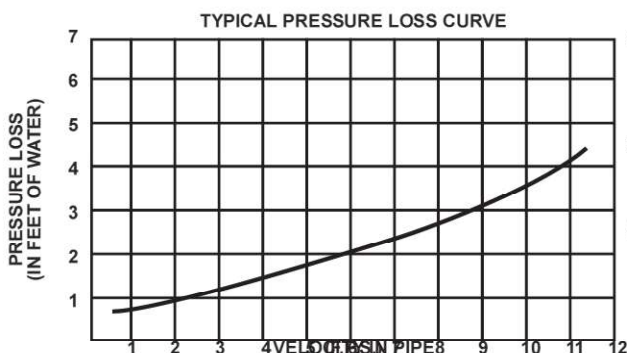

NOTE: For specific valve size pressure loss curve . . . see drwg. No. 1404.

**VAL-MATIC SILENT CHECK VALVES ARE ENGINEERED FOR SILENT OPERATION / LOW HEAD LOSS *Plus...***

- Double guided disc
- Large bearing surfaces
- Easily Replaceable Parts
- Functions Equally Well in All Positions
- Replaceable bronze bushing
- Drop-Tight Sealing
- Cast Iron Body / Bronze or Stainless Steel Trim
- Mate-ability . . . Sizes 3" thru 10" valves mate to Wafer style butterfly valves without the use of spool pieces or any other adaptors.

NOTE:

1. Val-Matic 1800 Series Globe-Style Silent Check Valves Are Intended for Liquid Service Only. For other service or materials of construction, consult factory.

2. Wafer Style Valves Also Available in 2" through 10" . . . See Val-Matic Bulletin 1400.

# VAL-MATIC

905 RIVERSIDE DRIVE ■ ELMHURST, IL 60126  
PHONE (630)941-7600 ■ FAX (630)941-8042

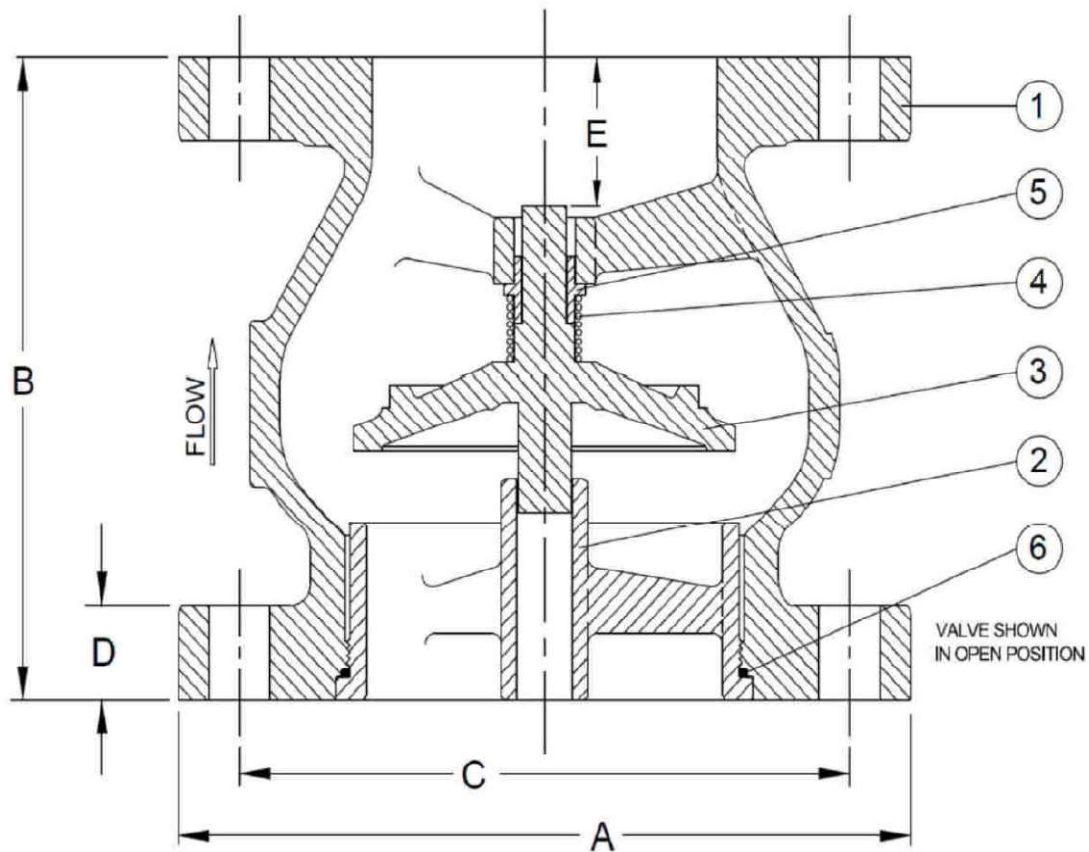

SEE DRAWING NO. VM-1800A-MSS-AND 3748-M FOR MATERIALS OF CONSTRUCTION

**BS4504 PN16 DIMENSIONS, MILLIMETERS**

VALVE SIZE	MODEL NO.	BR. TRIM	316SS TRIM	CWP BAR	A	B	C	D	E
65	1825A	HKXF	X005	16	178	140	145	18	25
80	1803A	HKXF	X006	16	191	152	160	27	35
100	1804A	HKXF	X006	16	220	184	180	27	44
150	1806A	HKXF	X006	16	285	248	240	27	63
200	1806A	HKXF	N/A	16	285	248	240	27	63

**GLOBE STYLE SILENT CHECK VALVE**

DATE 6-8-18

**VAL-MATIC**® VALVE AND MANUFACTURING CORP.

DRWG. NO.  
**VM-1800A**