



WF661S WAFER TYPE CHECK VALVE

Product Characteristic and features

- * Centrally supported Disc, maintenance free
- * Fast closing speed with spring assistance.
- * Low resistance to flow
- * Epoxy coated body to prevent corrosion
- * Wafer type for flanges acc. To BS EN1092-2
- * Face-to-face acc. To BS EN558-1 basic series 16

Design

Pressure rating	16 bar
Temperature rating	Ambient to Max 85°C
Body	Flangeless wafer type
End connection	EN1092-2 PN16
Face to Face	EN558-1/2, Series 16
Body Seat	Resilient seat

Testing

Body Strength test	BSEN 12266-1, 24 bar
Seat tightness test	BSEN 12266-1, 17.6 bar, Rate A ISO 5208 rate A
Operability test	BSEN 12266-2, F20

Approval

Epoxy Coating	WRAS approved
---------------	---------------

Material of Construct

Item	Parts	Material Standard
1	Body*	Ductile Iron EN-GJS-500-7 with epoxy
2	Disc	Stainless steel BSEN 10088 1.4401
3	Seat	EPDM / NBR
4	Shaft	St. St. BSEN 10088 1.4301 / 1.4401
5	Spring	St. St. BSEN 10088 1.4301 / 1.4401 Inconel 625 UNSN06625 Ni-Cr Alloy

Body Marking

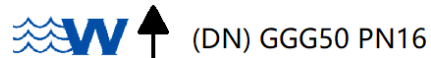

Remarks

- * Cast St. St. 316 body and fully vulcanized Ductile Iron body available.

WF661S WAFER TYPE CHECK VALVE

Dimension Data

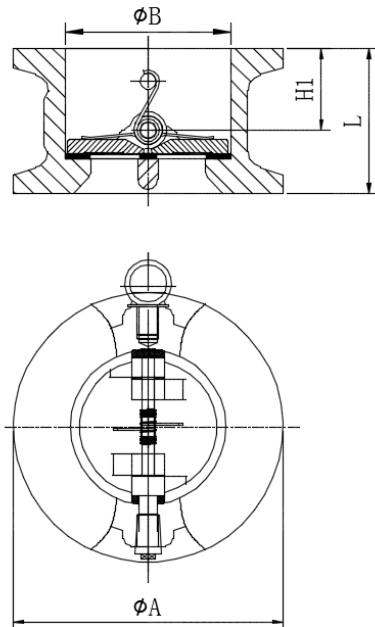

Size	ØA	ØB	L	H1
50	107	65	43	19
65	127	80	46	20
80	142	94	64	28
100	162	117	64	28
125	192	145	70	30
150	217	170	76	31
200	272	224	89	33
250	328	265	114	50
300	383	310	114	50
350	443	360	127	45
400	495	410	140	52
450	555	466	152	58
500	617	505	152	58
600	734	624	178	73

Installation

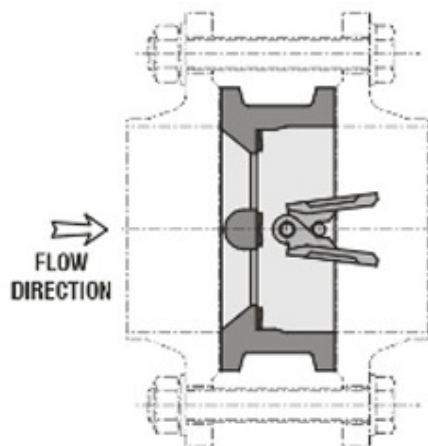

Wafer type check valve is for clamping between the two flanges ends of the pipe

- Gasket should cut to the valve bore and do not intervene the disc