

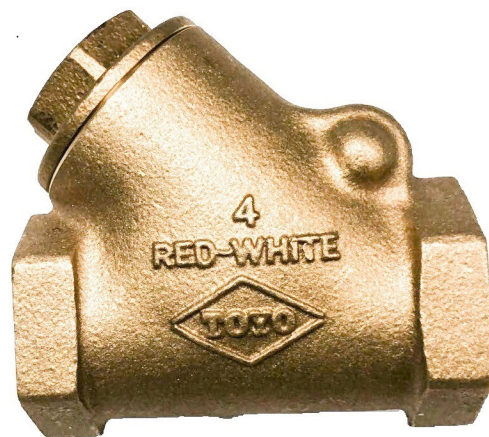

CLASS 300 BRONZE CHECK VALVE

Swing type, Y-pattern, screwed cap, screwed ends.

MSS Specification Valves

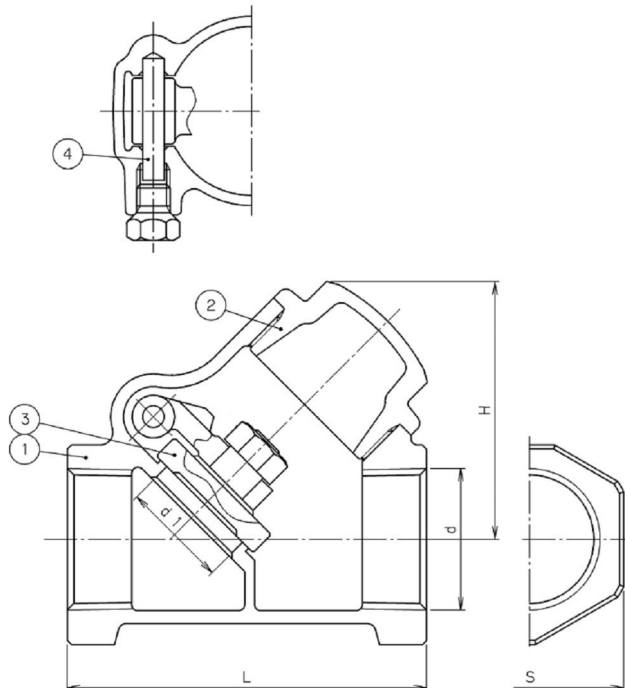

BODY MARKING

Working Pressure

Working Pressure Non-Shock		Test Pressure	
Saturated Steam	Cold Water Oil, Gas	Shell (Water)	Seat (Water)
20.6 Bar	63 Bar	94.5 Bar	69.3 Bar

Materials

No.	Name of Parts	Materials	ASTM	BS Equivalent
1	Body	Cast Bronze	B61-C92200	BSEN1982-CC491K
2	Cap	Cast Bronze	B61-C92200	BSEN1982-CC491K
3	Disc	Cast Bronze	B61-C92200	BSEN1982-CC491K
4	Hinge Pin	Copper	B3	

Dimensions

unit : mm

SIZE		d1	H	L	S	MASS (kg)
A	d					
15	1/2	13	42	60	29	0.31
20	3/4	19	51	72	35	0.50
25	1	25	61	84	44	0.79
32	1¼	32	74	99	54	1.28
40	1½	38	83	113	60	1.78
50	2	50	98	131	74	2.77

Note:

1. End threads conform to BS EN 10226 (formerly BS21 taper, NPT thread also available).
2. These valves conform to MSS SP-80 and meets requirement of BS 5154.