

AVK FLANGED BALL CHECK VALVE, PN 10

53/35
003

Ball check valve with flanges, for sewage and neutral liquids to max. 70° C, designed according to DIN/EN, face to face according to DIN 3202 - F6.
Standard flange drilling to EN1092-2 (ISO 7005-2)
Hydraulic test according to EN12050-4.
Approved according to LGA regulations.

Ball check valve designed according to EN 12050-4.
Body and cover of ductile iron GJS-400-15 (GGG-40). Ball of aluminium in DN 50-100 and ductile iron in DN 125-400, vulcanized with NBR rubber. DN 500 is with aluminium core and NBR liner.
DN 600 aluminium core and PUR liner.
Bolts and nuts of stainless steel A2 and cover gasket of NBR rubber.
AVK coating standard.



For further details see section "Technical Information".
The designs, materials and specifications shown are subject to change without notice due to the continuous development of our product programme.

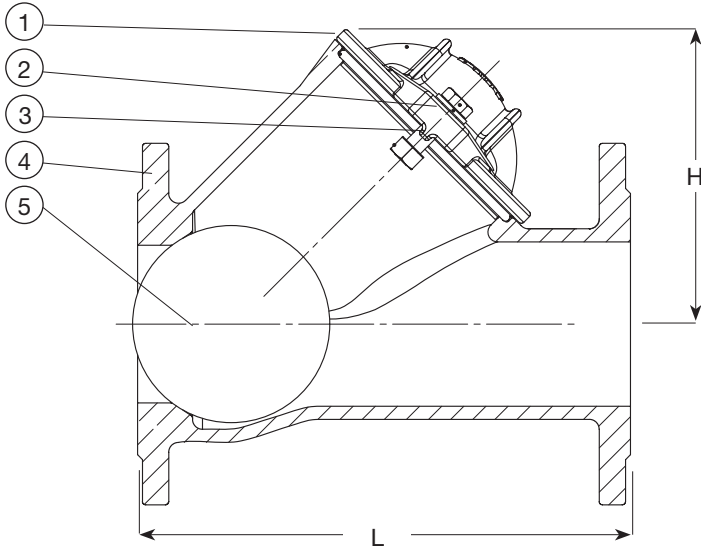

Features

The valve design features 100% free flow as the ball does not appear in the valve flow path when in open position. The straight bore prevents deposits in the valve. Consequently the AVK ball check valves feature a very low pressure loss giving the benefits of optimum use of pump capacity.

Tightness is secured when installed both vertically and horizontally, even at very low counter pressure. At horizontal installation the ball will be placed in almost closed position, as the valve body supports the ball against the seat. The ball is rotating during operation thus giving a self-cleaning function and minimum wear of the rubber.

The rubber hardness is carefully defined to prevent the ball from getting stuck in the seat.

The check valves are optionally available with different ball weights and balls of solid PUR in standard weights.

Component list

- | |
|--------------------|
| 1. Cover |
| 2. Bolt/nut/washer |
| 3. Gasket |
| 4. Body |
| 5. Ball |

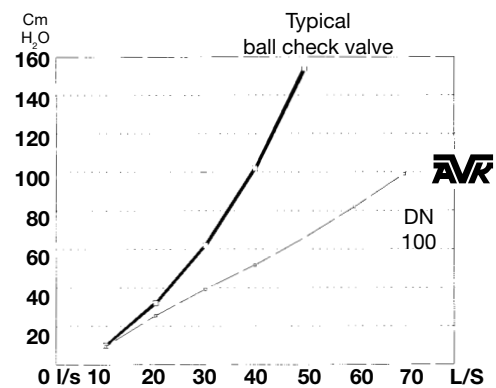

Reference nos. and dimensions

AVK ref. nos.	DN mm	PN drilling	L mm	H mm	Theoretical weight kg
53-050-35-1007	50	10/16	200	101	7,5
53-065-35-1007	65	10/16	230	148	12
53-080-35-1007	80	10/16	260	148	13
53-100-35-1007	100	10/16	300	182	18
53-125-35-1007	125	10/16	350	251	35
53-150-35-1007	150	10/16	400	251	37
53-200-35-0007	200	10	500	333	68
53-250-35-0007	250	10	600	406	112
53-250-35-1007	250	16	600	406	112
53-300-35-0007	300	10	700	480	163
53-300-35-1007	300	16	700	480	163
53-350-35-0007	350	10	800	571	289
53-400-35-0007	400	10	900	657	416
53-500-35-0007	500	10	1100	930	712
53-600-35-0207 #)	600	10	1300	1010	1200

Supplied with PUR ball as standard